

PLAN SUBJECT TO POSSIBLE MODIFICATIONS FOR TECHNICAL OR LEGAL REASONS. THE MEASUREMENTS SHOWN ARE APPROXIMATE  
 PLANO SUJETO A POSIBLES MODIFICACIONES DE INDOLE TÉCNICA O JURÍDICA. LAS SUPERFICIES SON APROXIMADAS

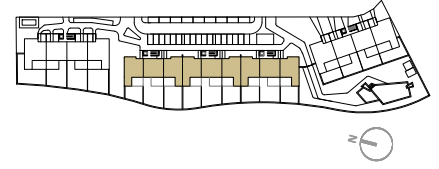

# RESIDENCIAL AZURE IV

LO ROMERO GOLF - PILAR DE LA HORADADA



## VIVIENDA TIPO V.99

### SUPERFICIES ÚTILES / OCCUPIABLE AREA

|                          |          |
|--------------------------|----------|
| LIVING ROOM - KITCHEN    | 35.00 m2 |
| PASO / CORRIDOR          | 1.55 m2  |
| DORMITORIO 1 / BEDROOM 1 | 14.10 m2 |
| BAÑO 1 / BATHROOM 1      | 3.50 m2  |
| DORMITORIO 2 / BEDROOM 2 | 10.30 m2 |
| BAÑO 2 / BATHROOM 2      | 3.50 m2  |

|                       |          |
|-----------------------|----------|
| TERRAZA 1 / TERRACE 1 | 19.75 m2 |
| JARDIN 1 / GARDEN 1   | 61.30 m2 |

### SUPERFICIES CONST. / BUILT AREA

|                                |           |
|--------------------------------|-----------|
| SUP. CERRADA / CLOSED AREA     | 82.85 m2  |
| CLOSED AREA + TERRACE          | 102.60 m2 |
| CLOSED AREA + TERRACE + GARDEN | 163.90 m2 |

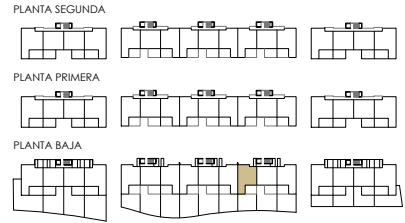

CONTACT: 0034 650 834 472  
 info@binomiumproperties.com  
 www.binomiumproperties.com